



**TDK-Lambda Americas Inc.**  
3055 Del Sol Blvd.  
San Diego, CA 92154 USA  
TEL. +1 619 575 4400 ~ FAX +1 619 429 1011  
Toll Free +1 800 LAMBDA-4  
<http://us.tdk-lambda.com/lp>

June 1, 2011.

**RE: NV & EFE Series Right Angled Output Connector Position Change.**

Implementation date: June 1, 2011.

Products affected: NV-100 / NV-175 / NV-175M / NVM-175 / NV-300 / EFE-300 / EFE300M / EFE-400 /  
EFE-400M.

The right angled output connector position of the above listed NV & EFE Series has been changed to improve the manufacturability of the products.

The only physical change is that the overall product length is now 0.65mm shorter.  
This change of less than 1mm length should have minimal impact on existing customer designs.

Please reference the included drawing to see an example of the change.  
(In this case the series shown is NV-175)

Regards,

Dorrel Vernon  
Product Manager  
TDK-Lambda Americas Inc  
3055 Del Sol Blvd  
San Diego, CA 92154

(619) 628 2223  
[dorrel.vernon@us.tdk-lambda.com](mailto:dorrel.vernon@us.tdk-lambda.com)

A

### OLD CONNECTOR

B

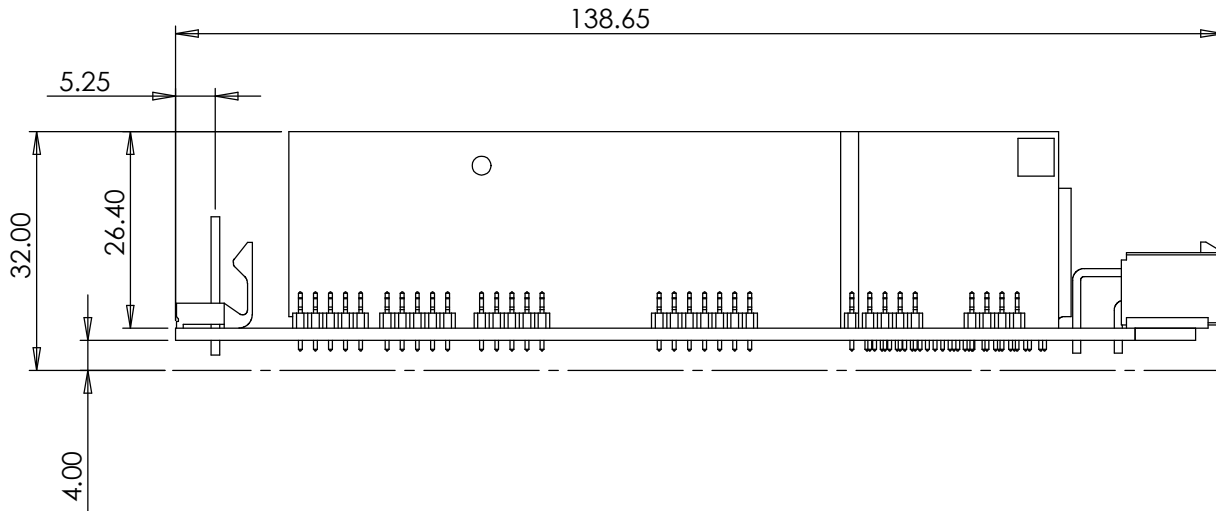

C

### NEW CONNECTOR

D

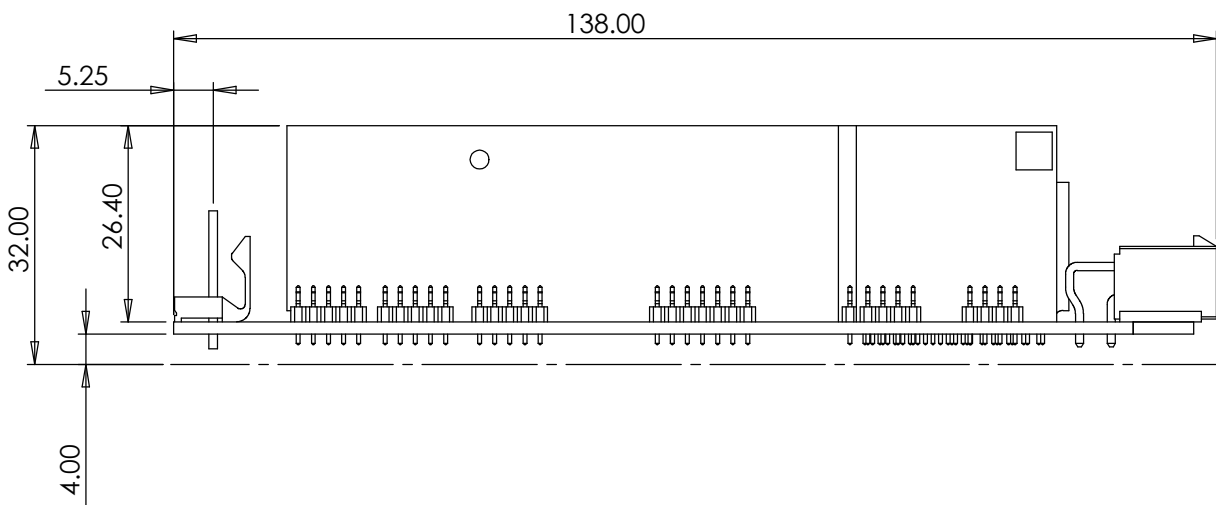

E

This drawing and any information or descriptive matter contained therein are the confidential and copyright property of TDK-Lambda UK Limited. Neither the whole nor any extract may be disclosed, loaned, copied or used for manufacturing or tendering purpose without their written consent.



F

MATERIAL SPECIFICATION N/A	<b>TDK-Lambda</b>  TDK-Lambda UK Limited. <a href="http://www.uk.tdk-lambda.com">http://www.uk.tdk-lambda.com</a>	TITLE NV 175 CUSTOMER LAYOUTS	SHEET 1/1
FINISH SPECIFICATION N/A		DRAWING NUMBER <b>NEW CONNECTOR POSITION</b>	DRAWN BY P.H. DATE N/A
COMMENTS UNSTATED TOL REFER TO 67960		PROJECT NV175	SCALE 1:1 DO NOT SCALE

This drawing is SolidWorks produced. All changes must be effected through the CAD System. Drawn to BS8888.

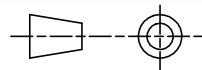

3RD ANGLE PROJECTION

UNLESS OTHERWISE STATED, DIMS IN mm.

# A4